

DH-HAC-HDW1231TLMQ(-A)

2MP Starlight HDCVI IR Quick-to-install Eyeball Camera



- Max 30 fps@1080p
- Starlight, 130 dB true WDR, 3D NR
- 3.6 mm fixed lens (2.8 mm optional)
- CVI/CVBS/AHD/TVI switchable
- Super Adapt
- Built-in mic(-A)
- Max. IR length 30m, Smart IR
- IP67, DC 12 V
- Quick-to-install saves installation time



System Overview

Lite Series is suitable for users who requires high quality monitoring products at a reasonable price. It is cost effective and offers high performance, which makes it an ideal choice for residential and small-medium business applications. This series offers an option of a wide range of technologies such as Full-color and Starlight, providing various solutions for different scenarios.

Functions

Starlight

With the adoption of large sized high performance sensor and large aperture lens, the camera is able to provide incomparable performance even under extreme lowlight environment. The starlight feature allows more details to be captured and accurate color to be recognized at night or in scenes with limited illumination.

Broadcast-quality Audio

Audio information is used as supplementary evidence in video surveillance applications. The HDCVI camera supports audio signal transmission over coaxial cable. In addition, it adopts unique audio processing and transmission technology that best restores source audio and eliminates noise, guaranteeing the quality and effectiveness of collected audio information.

* Audio input is available for some models of HDCVI cameras.

Wide Dynamic Range

With advanced Wide Dynamic Range (WDR) technology, Dahua HDCVI camera provides clear details in the environment of strong brightness contrast. The bright and dark area can get clear video even in high brightness environment or with backlight shadow.

Super Adapt

Embedded with intelligent algorithm, for changing external environment, camera can automatically adjust parameters to present the optimal image, and it solves the trouble of configuration.

Advanced 3DNR

3DNR is noise reduction technology that detects and eliminates random noises by comparing two sequential frames. Dahua's advanced 3DNR technology allows remarkable noise reduction with little impact to sharpness, especially under limited lighting condition. Besides, the advanced 3DNR effectively decreases the band width and saves the storage space.

Smart Illumination

The camera is designed with IR illumination for best lowlight performance. Smart IR is a technology to ensure brightness uniformity in B/W image under low illumination. Dahua's unique Smart IR adjusts to the intensity of camera's infrared LEDs to compensate for the distance of an object, and prevents IR LEDs from overexposing images as the object come closer to the camera.

Easy Installation

HDCVI quick-to-install eyeball adopts quick-to-install pedestal, which can achieve easier installation than conventional eyeball. Quick-to-install camera reduces time and labor costs.

Protection (IP67, wide voltage)

IP67: The camera passes a series of strict test on dust and soak. It has dust-proof function, and the enclosure can works normal after soaking in 1 m deep water for 30 minutes.

Wide voltage: The camera allows $\pm 30\%$ (for some power supplies) input voltage tolerance (wide voltage range), and it is widely applied to outdoor environment with instable voltage.

Technical Specification						Day/Night		Auto switch by ICR	
Camera						BLC		BLC/WDR/HLC	
Image Sensor		1/2.8" CMOS				WDR		130 dB	
Max. Resolution		1920 (H) × 1080 (V)				White Balance		Auto; Area WB	
Pixel		2MP				Gain Control		Auto; manual	
Scanning System		Progressive				Noise Reduction		3D NR	
Electronic Shutter Speed		PAL: 1/25 s–1/100,000 s NTSC: 1/30 s–1/100,000 s				Smart IR		Yes	
S/N Ratio		> 65 dB				Mirror		Off/On	
Min. Illumination		0.002 Lux/F1.6, 30 IRE, 0 Lux IR on				Privacy Masking		Off/On (8 area, rectangle)	
Illumination Distance		30 m (98.4 ft)				Certifications			
Illuminator On/Off Control		Auto; manual				Certifications		CE (EN55032, EN55024, EN50130-4) FCC (CFR 47 FCC Part 15 subpartB, ANSI C63.4-2014) UL (UL60950-1+CAN/CSA C22.2 No.60950-1)	
Illuminator Number		1 (IR light)				Port			
Pan/Tilt/Rotation Range		Pan: 0°–360° Tilt: 0°–78° Rotation: 0°–360°				Video Output		Video output choices of CVI/TVI/AHD/CVBS by one BNC port	
Lens		Fixed lens				Audio Input		One channel built-in mic (-A)	
Mount Type		M12				Power			
Focal Length		2.8 mm; 3.6 mm				Power Supply		12 V ±30% DC	
Max. Aperture		F1.6				Power Consumption		Max 3.1 W (12 V DC, IR on)	
Field of View		2.8 mm: H: 107°; V: 56°; D: 127° 3.6 mm: H: 86°; V: 46°; D: 101°				Environment			
Iris Type		Fixed iris				Operating Temperature		–40 °C to +60 °C (–40 °F to 140 °F); < 95% (non-condensation)	
Close Focus Distance		2.8 mm: 0.7 m (2.3 ft) 3.6 mm: 1.1 m (3.6 ft)				Storage Temperature		–40 °C to +60 °C (–40 °F to 140 °F); < 95% (non-condensation)	
DORI Distance	Lens	Detect	Observe	Recognize	Identify	Protection Grade			
	2.8 mm	43.9 m (144 ft)	17.5 m (57.4 ft)	8.8 m (28.9 ft)	4.4 m (14.4 ft)	Structure			
	3.6 mm	53.7 m (176.2 ft)	21.5 m (70.5 ft)	10.7 m (35.1 ft)	5.4 m (17.7 ft)	Casing			
	*DORI (Detect, Observe, Recognize, Identify) is a standard system (EN-62676-4) for defining the ability of a person viewing the video to distinguish persons or objects within a covered area. The numbers in this table do not reflect intelligent function distances. For intelligent function distances, refer to installation and commissioning manual/project design tool.					Metal dome+metal cover+plastic decorative ring			
Camera Dimensions		Φ109.9 mm × 88.1 mm (Φ4.33" × 3.47")				Net Weight		0.28 kg (0.62 lb)	
Gross Weight		0.45 kg (0.99 lb)							
Video									
Frame Rate		CVI: PAL: 1080p@25 fps; NTSC: 1080p@30 fps; AHD: PAL: 1080p@25 fps; NTSC: 1080p@30 fps; TVI: PAL: 1080p@25 fps; NTSC: 1080p@30 fps; CVBS: PAL: 960 × 576H; NTSC: 960 × 480H							
Resolution		1080p (1920 × 1080); 960H (960 × 576/960 × 480)							

Ordering Information		
Type	Model	Description
2M Camera	DH-HAC-HDW1231TLMQP-A	2MP Starlight HDCVI IR Quick-to-install Eyeball Camera, PAL
	DH-HAC-HDW1231TLMQN-A	2MP Starlight HDCVI IR Quick-to-install Eyeball Camera, NTSC
	DH-HAC-HDW1231TLMQP	2MP Starlight HDCVI IR Quick-to-install Eyeball Camera, PAL
	DH-HAC-HDW1231TLMQN	2MP Starlight HDCVI IR Quick-to-install Eyeball Camera, NTSC
Accessories (Optional)	PFA13G	Junction box
	PFA130-E	IP66 Junction box
	PFB205W	Wall Mount Bracket (For use alone or with PFA152-E)
	PFA152-E	Pole Mount Bracket (For use with PFB205W)
	PFM800-E	Passive HDCVI Balun
	PFM321	12V 1A Power Adapter
	PFM904	Integrated Mount Tester

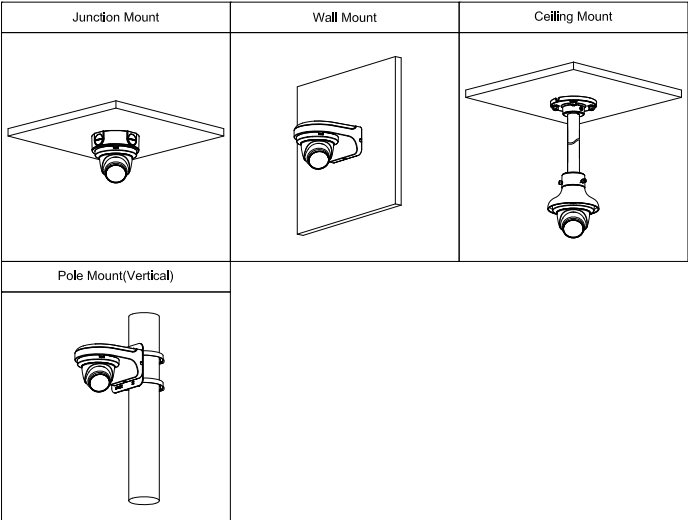

Dimensions (mm[inch])

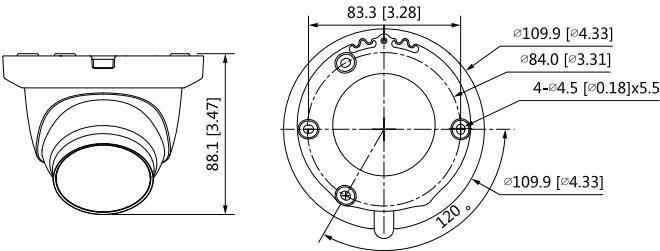

Accessories

Optional:



PFA13G
Junction box



PFA130-E
IP66 Junction box



PFB205W
Wall Mount Bracket
(For use alone or with
PFA152-E)



PFA152-E
Pole Mount Bracket
(For use with PFB205W)



PFM800-E
Passive HDCVI Balun



PFM321
12 V 1A Power Adapter



PFM904
Integrated Mount Tester